

## WARNING

## READ BEFORE INSTALLATION

Installation must be carried out by a qualified electrician only.

- Disconnect power before installing.
- Do not exceed specified power rating.
- Do not connect luminaire directly to mains power. Luminaire must be connected to an LED driver.
- Control system connected to driver NOT Luminaire
- Ensure correct polarity of all LED & control connections.
- In the event of tripping or irregular operation, disconnect power mains and connection to luminaire before investigating the problem.

## Provided (Per Fitting)

## You will need

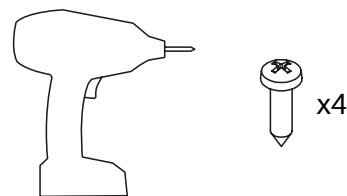
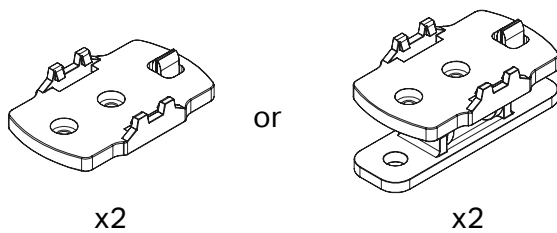

## Installation Considerations

- 1 Use 2 brackets per fitting

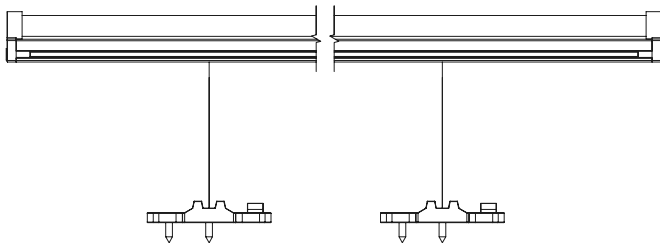

- 2 Brackets should be spaced equally. The gap between the brackets should be a minimum of 1/3 the length.

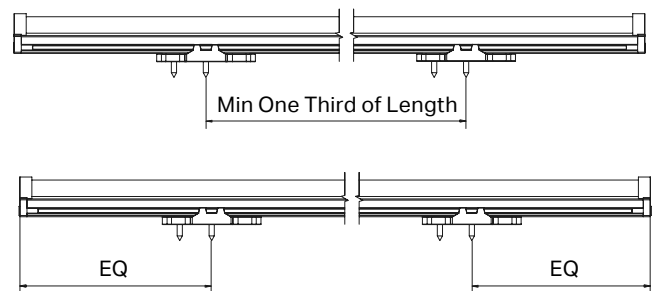

## Spacing between fittings

- 1 Leave a minimum 5mm gap between blank ends.

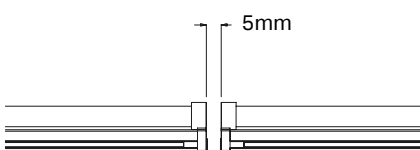

- 2 Leave a minimum 5mm gap between wired ends.

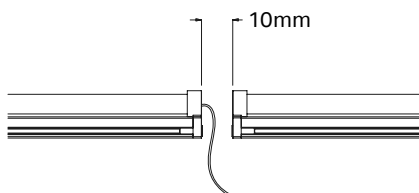

- 3 Leave a minimum 10mm gap between linked ends.

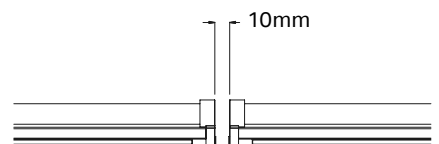

## Surface Mount Installation

- 1** Drill pilot holes and fasten bracket to surface. Ensure hole centres are aligned.

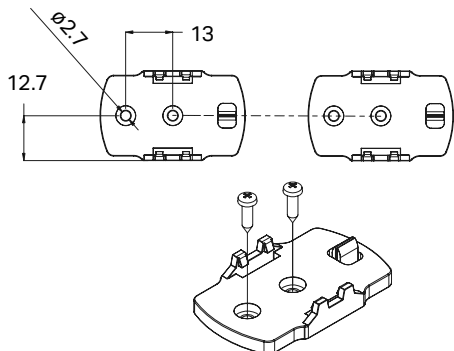

- 2** Push Azuna fitting into snap fit bracket.

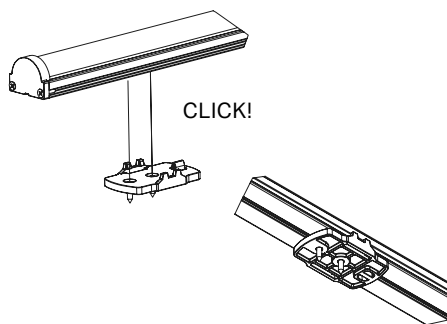

- 3** if adjustment needed, slide fitting to desired position.



## Adjustable Bracket Installation

- 1** Drill pilot holes and fasten bracket to surface. Adjust bracket angle (Max 50°)

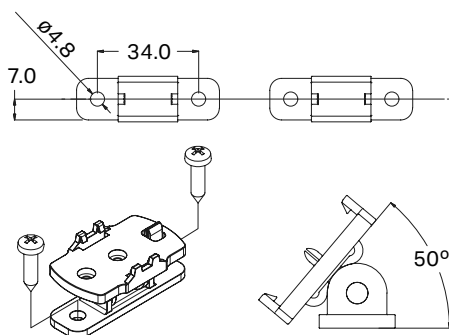

- 2** Push Azuna fitting into snap fit bracket.

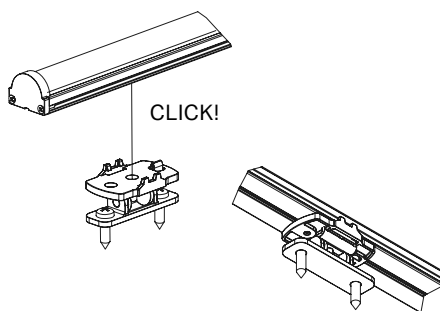

- 3** if adjustment needed, slide fitting to desired position.

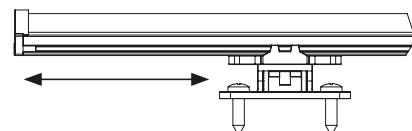

## Wiring Diagrams

### Switched

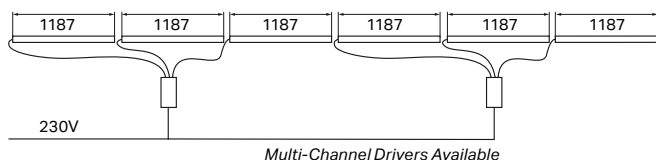

### DALI

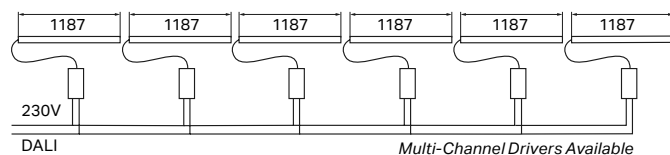

### 0-10V

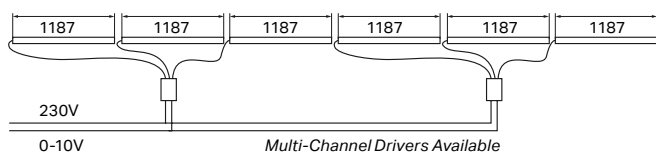

### Phase Dimming

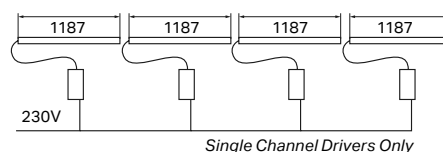

Azuna-0822



**Contact Us**

0113 263 9039

[sales@kempslighting.com](mailto:sales@kempslighting.com)

[kempsarchitecturallighting.com](http://kempsarchitecturallighting.com)

**MADE IN  
BRITAIN**