

Figaro 40 A-R Recessed Trimless Installation Guide

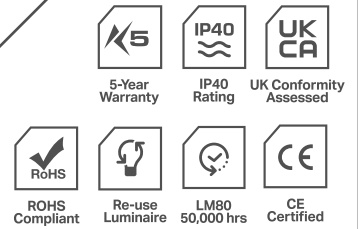

Dimensions

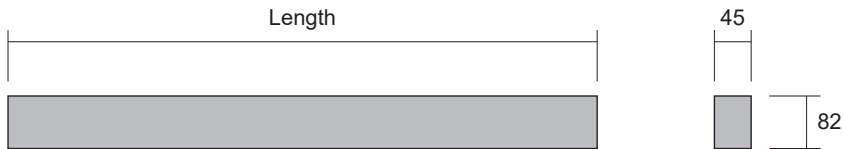

Installation

- 1 Prepare ceiling cut out. Recommended:
W 49mm max., L product length +4mm max.

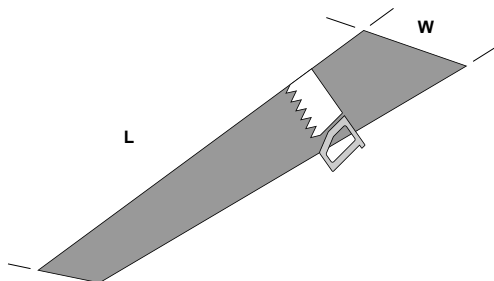

- 3 Place the brackets into the ceiling cut out and fasten in place with screws through the ceiling substrate.

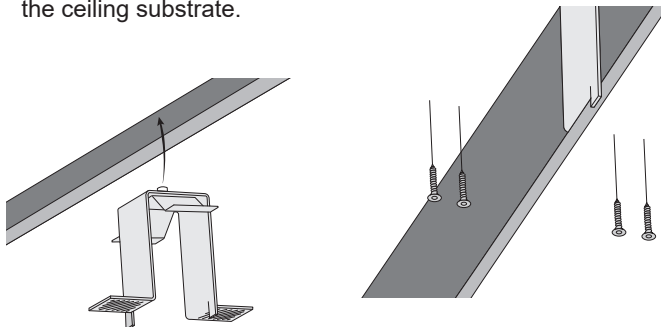

- 5 If there are multiple profiles, insert the top joining plate and 2x side joining plates halfway into the profile end. Connect the mating profile and tighten the 4x grub screws in the top plate to lock the profiles together.

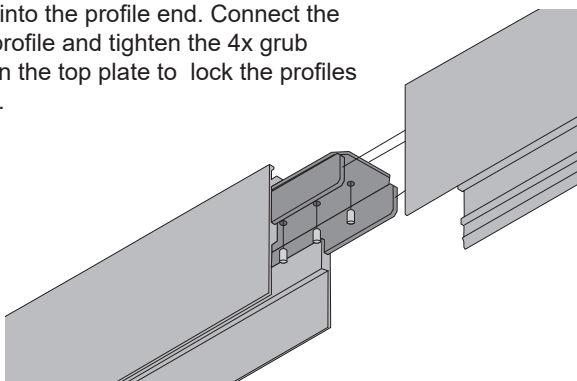

- 2 Unclip diffusers and gear trays from all fittings. Disconnect any electrical connections between gear trays. Keep parts together for ease of installation.

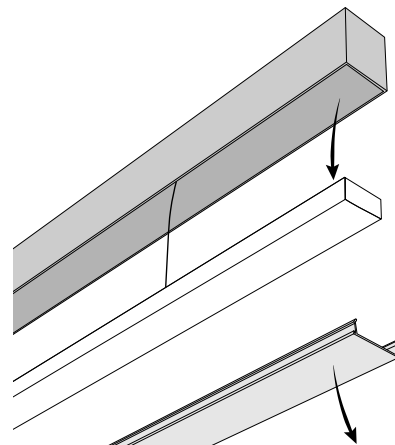

- 4 Using the included M5 bolts, fasten the profile to the brackets. Incrementally tighten all bolts until the profile engages the bracket springs. Continue tightening until the bottom edges are at finished ceiling level.

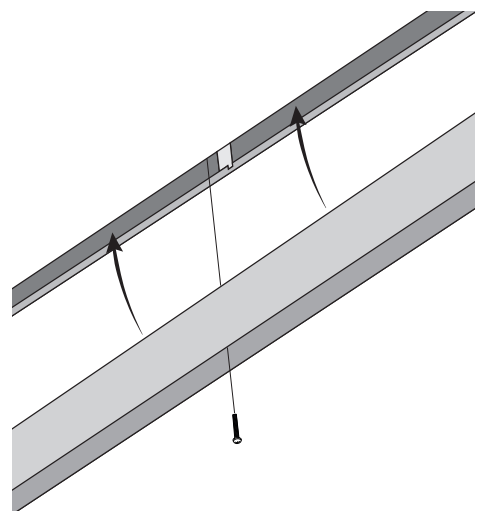

Figaro 40 A-R Recessed Trimless Installation Guide



Installation Continued

- 6** Clip all gear trays back into the profiles as indicated whilst reconnecting any electrical connections. Take care not to trap any cables when inserting gear trays. Complete all earth connections by inserting the profile earth cable into the Wago connectors on the corresponding gear tray.

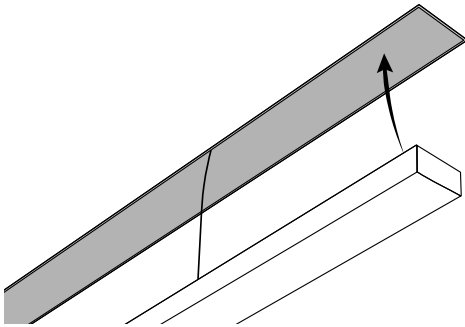

- 7** Snap all diffusers back into the profiles.

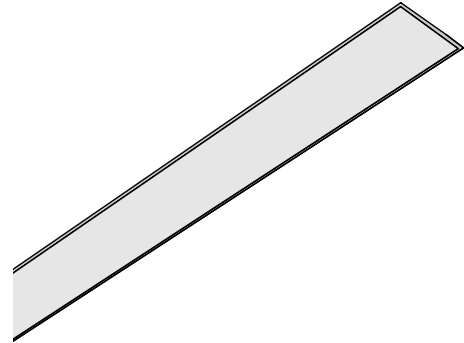

Wiring

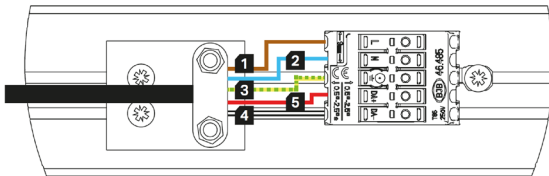

Connect the mains and DALI at the necessary points. Connections to the terminal block are as follows:

- | | |
|--------------------------------|-----------------------------------|
| 1. Brown: Live | 4. White: DALI 1 or 0-10V- |
| 2. Blue: Neutral | 5. Red: DALI 2 or 0-10V+ |
| 3. Green/ Yellow: Earth | |



- Electrical termination to be carried out by a qualified electrician.
- Disconnect power before installation.
- Unpack the product carefully and read all supplied documentation.
- Refer to specification for operating conditions and do not exceed specified power rating.
- Ensure correct polarity of all mains & control connections.
- Take care to avoid snagged or trapping wires during luminaire installation.
- Fixings not supplied. Ensure fixings are suitable for product weight and mounting surface.
- In the event of tripping or irregular operation, disconnect mains power from luminaire before investigating.



- Luminaires should be cleaned in conjunction with the design maintenance program.
- Clean with a mild neutral detergent warm water mix (55°C max). Wash gently with a soft clean cloth.
- Electrical components or cabling must not be exposed to cleaning agent or water. It is always important to disconnect the power supply before cleaning.